

# 2017

## TOP UTAH ARCHITECTURAL FIRMS

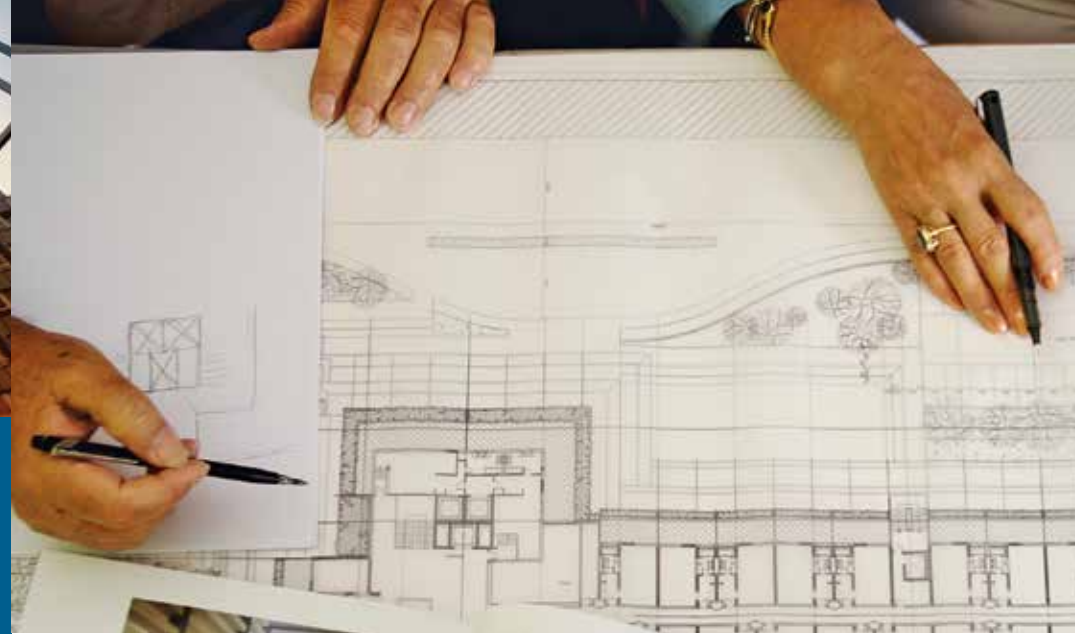

Utah Construction & Design is pleased to publish its 5th annual list of the Top Architectural Firms in Utah, based on revenues generated in 2016 by a firm's Utah offices. Projects outside of Utah that are billed to Utah-based offices are included. Firms who chose not to disclose revenues (DND) are ranked after revenue-disclosing firms by number of employees.



Firm Name Address	Phone Website	Year Est.	Top Executive Title Years at Firm	Largest Project to Finish 2016 Largest Project to Start 2017	# Employees # Lic. Archs # LEED AP	Annual Revenues (millions)			Top Markets	%
						2016	2015	2014		
<b>1. VCBO Architecture</b> 524 S. 600 E. SLC, UT 84102	(801) 575-8800 www.vcbo.com	1973	Brent Tippetts President 33	WSU Tracy Hall Science Building USU Life Sciences Building	87 26 14	<b>\$28.0</b>	\$26.0	\$21	K-12 Higher Ed Other	24% 23% 22%
<b>2. FFKR Architects</b> 730 Pacific Ave. SLC, UT 84104	(801) 521-6186 www.ffkr.com	1976	Roger Jackson FAIA 33	BioFire Diagnostics, SLC Health Sciences Transformation Project	122 54 16	<b>\$27.0</b>	\$23.0	\$17.3	K-12 Healthcare Other	27% 29% 16%
<b>3. GSBS Architects</b> 375 W. 200 S. Ste. 100 SLC, UT 84101	(801) 521-8600 www.gsbsarchitects.com	1978	Kevin Miller President/CEO 29	Cottonwood Heights Municipal Center Utah State Prison, SLC	74 27 27	<b>\$17.3</b>	\$15.1	\$11.5	Civic/Inst. Other Industrial	31% 26% 15%
<b>4. Architectural Nexus</b> 2505 Parley's Way SLC, UT 84109	(801) 924-5000 www.archnexus.com	2003	Kenner Kingston President 21	Ft. Collins Colorado Temple New Hospital Facility, Idaho	102 38 25	<b>\$16.8</b>	\$17.8	\$17.4	Healthcare Other Civic/Inst.	33% 23% 17%
<b>5. MHTN Architects</b> 420 E. South Temple Ste. 100 SLC, UT 84111	(801) 595-6700 www.mhtn.com	1923	Peggy McDonough-Jan President 15	BYU Auxiliary Laundry Bldg. Merit Medical R&D Bldg.	68 32 15	<b>\$14.3</b>	\$11.6	\$11.1	K-12 Higher Ed Civic/Inst.	34% 23% 16%
<b>6. Method Studio</b> 925 S. West Temple SLC, UT 84101	(801) 532-4422 www.method-studio.com	2007	Becky Hawkins CEO 10	USU Maverick Stadium Reno. UVU Performing Arts Center	66 19 12	<b>\$12.1</b>	\$7.6	\$4.4	Higher Ed Multi-Family Other	35% 30% 25%
<b>7. NWL Architects</b> 336 S. 400 W. SLC, UT 84101	(801) 355-5959 www.nwlarchitects.com	1952	Christopher Lund President 24	Idaho Falls LDS Temple Reno. Eagle Mountain High School	48 17 8	<b>\$11.5</b>	\$12.1	\$9.1	K-12 Civic/Inst. Higher Ed	48% 1% 1%
<b>8. CRSA</b> 649 E. South Temple SLC, UT 84102	(801) 355-5915 www.crsa-usa.com	1975	Kathy Wheadon President 16	DND DND	59 20 7	<b>\$9.3</b>	\$9.8	\$10.4	Civic/Inst. Higher Ed Other	42% 20% 17%
<b>9. Think Architecture, Inc.</b> 5151 S. 900 E. Ste. 200 SLC, UT 84117	(801) 269-0055 www.thinkaec.com (Rebranded 2012)	1980	Corey Solum President 17	Stein Eriksen Lodges, Deer Valley The Apex - Summit County	42 16 1	<b>\$8.1</b>	\$8.9	\$7.9	Office Resort/Hosp. Comm/Retail	25% 20% 20%
<b>10. EDA Architects</b> 9 Exchange Place Ste. 1100 SLC, UT 84111	(801) 531-7600 www.edaarch.com	1955	Robert Herman President 16	Overstock.com Corp. HQ DND	36 12 7	<b>\$7.3</b>	\$7.4	\$8.6	Higher Ed Civic/Inst. K-12	40% 19% 15%

## UTAH'S ECONOMY STAYING CONSISTENT FOR ARCHITECTS

*Architectural firms by-and-large posted solid revenue numbers from 2015 to 2016, or remained within 5% of previous year.*

Of the 21 firms who disclosed 2016 revenues for UC&D's 2017 Top Utah Architect rankings (three firms did not disclose revenues), 13 reported overall revenue increases from the previous year, with 9 of the 13 posting impressive double figure jumps. WPA (65%), Method (59%), JRCA (56%), TSA (33%), AE Urbia (28%) and MHTN (23%) all cracked the 20%+ mark; FFKR (17%), GSBS (15%), and Babcock Design Group (13%) hit double digits.

WPA went from just over \$1 million to \$1.7, Method saw a sizeable \$4.5 million jump (\$7.6 to \$12.1), JRCA spiked \$1 million to \$2.8, TSA bumped up half a million to an even \$2 million, AE Urbia hit \$6 million (\$1.3 million gain), and MHTN toppled \$14 million (\$14.3 million, a \$2.7 million increase).

VCBO maintained its spot atop the rankings for the third straight year with \$28 million, with FFKR right behind at \$27 million. GSBS was third at \$17.3 million, followed closely by Architectural Nexus (\$16.8 million) and MHTN (\$14.3). Method moved from ninth last year to No. 6 at \$12.1 million; NWL was the only other firm over \$10 million at \$11.5 million, just slightly down from 2015. >>

# 2017 TOP UTAH ARCHITECTURAL FIRMS

Firm Name Address	Phone Website	Year Est.	Top Executive Title Years at Firm	Largest Project to Finish 2016 Largest Project to Start 2017	# Employees # Lic. Archs # LEEDAP	Annual Revenues (millions)			Top Markets	%
						2016	2015	2014		
<b>11. Babcock Design Group</b> 52 Exchange Place SLC, UT 84111	(801) 531-1144 www.babcockdesign.com	1984	Robert Cottle CEO 17	Boise City Center Plaza UPS Regional Hub, SLC	27 13 5	<b>\$6.2</b>	\$5.5	\$6.3	Office Comm/Retail Healthcare	40% 30% 12%
<b>12. AE Urbia</b> 2875 S. Decker Lake Dr. Ste. 275 SLC, UT 84119	(801) 746-0456 www.aeurbia.com	2004	James Williams President 12	Entrata Office Bldg. Murray Crossing Apartments	25 3 2	<b>\$6.0</b>	\$4.7	\$4.0	Industrial Office Multi-Family	25% 20% 20%
<b>13. Design West Architects</b> 795 North 400 West SLC, UT 84103	(801) 539-8221 www.designwestarchitects.com	1892	Blake Wright President 29	Ridgeline High School SLC Mosquito Abatement Dist. HQ	30 13 1	<b>\$4.2</b>	\$4.9	\$6.2	K-12 Civic/Inst. Comm/Retail	35% 15% 15%
<b>14. Curtis Miner Architecture</b> 233 S Pleasant Grove Blvd. Pleasant Grove, UT 84062	(801) 769-3000 www.cmautah.com	1998	Curtis Miner Architect 18	Ken Garff Porsche/Audi, Lehi Rockpoint Apartments, Bluffdale	21 6 0	<b>\$3.5</b>	\$3.4	\$2.5	Multi-Family Comm/Retail Office	30% 20% 20%
<b>15. Prescott Muir Architects</b> 171 W. Pierpont Ave. SLC, UT 84101	(801) 521-9111 www.prescottmuir.com	1976	Prescott Muir President 41	Weber County Library Headquarters DND	19 5 1	<b>\$3.0</b>	\$3.0	\$3.0	Comm/Retail Higher Ed Office	60% 10% 10%
<b>16. JRCA</b> 577 S. 200 E. SLC, UT 84111	(801) 533-2100 www.jrcadesign.com	1983	Jim Child President 34	Utah Valley Dispatch Center West Jordan Public Works	12 4 3	<b>\$2.8</b>	DND	DND	DND DND DND	
<b>17. NJRA Architects</b> 5272 S. College Dr. Ste. 104 SLC, UT 84111	(801) 364-9259 www.njraarchitects.com	1977	Selvam Rajavelu President 27	Riverton Hospital Expansion Logan Reg. Hospital Cancer Center Expansion	16 5 4	<b>\$2.6</b>	\$2.8	\$2.3	Healthcare K-12	55% 45%
<b>18. TSA Architects</b> 17 Exchange Place SLC, UT 84111	(801) 463-7108 www.tsa-usa.com	1996	Tracy Stocking President 20	Jordan Valley Cancer Center Mountain View Care Center, Heber	12 6	<b>\$2.0</b>	\$1.5	\$1.5	Healthcare Higher Ed	90% 10%
<b>19. Case, Lowe &amp; Hart</b> 2484 Washington Blvd Ogden, UT 84401	(801) 399-5821 www.clhae.com	1963	Steve Peterson CEO 11	Medical Airport Hangar, Ketchikan AK Medical Airport Hangar, Gallup NM	12 1 2	<b>\$1.9</b>	\$2.6	\$2.0	Industrial Healthcare Other	62% 26% 11%
<b>20. WPA Architecture</b> 475 N Freedom Blvd. Provo, UT 84601	(801) 374-0800 www.wpa-architecture.com	1994	Alan Poulson President 23	Santaquin City Public Works Stein Eriksen Lodge - Phase VI	10 3 1	<b>\$1.7</b>	\$1.0	\$1.0	Resort/Hosp. Civic/Inst. Multi-Family	37% 15% 13%
<b>21. PGAW, Inc.</b> 5263 S. Commerce Dr. Murray, UT 84107	(801) 266-4669 www.pgaw.net	1963	Kris Pasker President 38	Deseret Industries, Springville Deseret Industries, Gilbert, AZ	9 3	<b>\$1.5</b>	\$1.4	\$1.9	Industrial Office Comm/Retail	30% 20% 19%
<b>FIRMS THAT DID NOT DISCLOSE REVENUES</b> (ranked by # of employees)										
<b>ajc architects</b> 703 E. 1700 S. SLC, UT 84105	(801) 466-8818 www.ajcarchitects.com	1991	Jill Jones President 26	The Ridge on Foothill Drive Blue Sky Lodge	24 9 5	DND	DND	DND	Higher Ed Multi-Family Resort/Hosp.	25% 20% 15%
<b>Archiplex Group, LLC</b> 255 Crossroad Square SLC, UT 84115	(801) 961-7070 www.archiplexgroup.com	2004	Ralph Stanislaw Principal 13	Central Utah Correctional Facility Addition Park City Fire District Fleet Svcs. Bldg.	9 3 2	DND	DND	DND	Civic/Inst. Comm/Retail Office	25% 20% 15%
<b>Dave Robinson Architects</b> 6465 S. 3000 E. Ste 102 SLC, UT 84121	(801) 272-0242 www.daverobinsonarchitects.com	1994	Dave Robinson President 23	CentrePointe C Journeyman Apprentice Training Center	7 2 1	DND	DND	DND	Industrial K-12 Comm/Retail	85% 10% 5%

## Market Analysis

Education (K-12 and Higher Ed), health care, civic/institutional remained among the hottest markets in the Beehive State, with commercial/office and multi-family also providing significant work for many firms.

In 2016, K-12 was the top market for VCBO (24% of all revenues), FFKR (27%), MHTN (34%), NWL (48%), and Design West (35%), second for NJRA (45%), and third for EDA (15%). Higher Education accounted for more than one-fifth of overall '16 revenues for six firms: VCBO (23%), MHTN (23%), Method (35%), CRSA (20%), EDA (40%), ajc (25%).

Health care remains another red-hot market (and should remain as such given the continual aging of the Baby Boomer generation) for Utah architects, with six firms ranking it among their Top 3 markets. This includes FFKR (29%), Nexus (33%), Babcock (10%), NJRA (55%), TSA (90%), and Case, Lowe & Hart (26%).

Babcock had the highest percentage from Commercial/Office projects at 40%; it was also the top market for Think Architecture (25%), the second best market for AE Urbia (20%) and PGAW (20%), and third for Curtis Miner (20%) and Archiplex Group (15%).

Multi-Family projects provided significant work for Method (30%), AE Urbia (20%), Curtis Miner (30%), WPA (13%), and ajc (20%). Commercial/Retail was strong for Think (20%), Babcock (30%), Design West (15%), Curtis Miner (20%), Prescott Muir (60%), PGAW (19%) and Archiplex Group (20%).

On the industrial front, Dave Robinson Architects reported 85% of its revenues coming from that market. Industrial was also the top market for AE Urbia (25%), Case, Lowe & Hart (62%), and PGAW (30%), and the third strongest for GSBS (15%). ■

## SPECIAL THANKS TO OUR LIST SPONSOR

